

Retrofit package available for the following brands:

- ▶Schlage(K)
- ▶Sargent
- ▶Corbin Russwin
- ▶Falcon
- ▶Emhart
- ▶Lockwood
- ▶Arrow
- ▶Yale
- ▶Marks
- ▶Best

*All brand names and trademarks are the property of their respective owners.

Available Trims:



Sentinel



Congress



Gala



Quest



Tango



Imperial



Artistic



Regal

Available Finishes:

- ▶US3 (Bright Brass)
- ▶US4 (Satin Brass)
- ▶Us26 (Bright Chrome)
- ▶US26D (Satin Chrome)
- ▶US32 (Bright SST)
- ▶US32D (Satin SST)

Technical Support:

Tel: (626) 858-5080
Fax: (626) 858-3393

sales@townsteel.com

TownSteel Inc.
707 N. Barranca Ave., Bldg #6, Covina, CA 91723

INSTALLATION GUIDE

RETROFIT

Trim Package

MRU Series



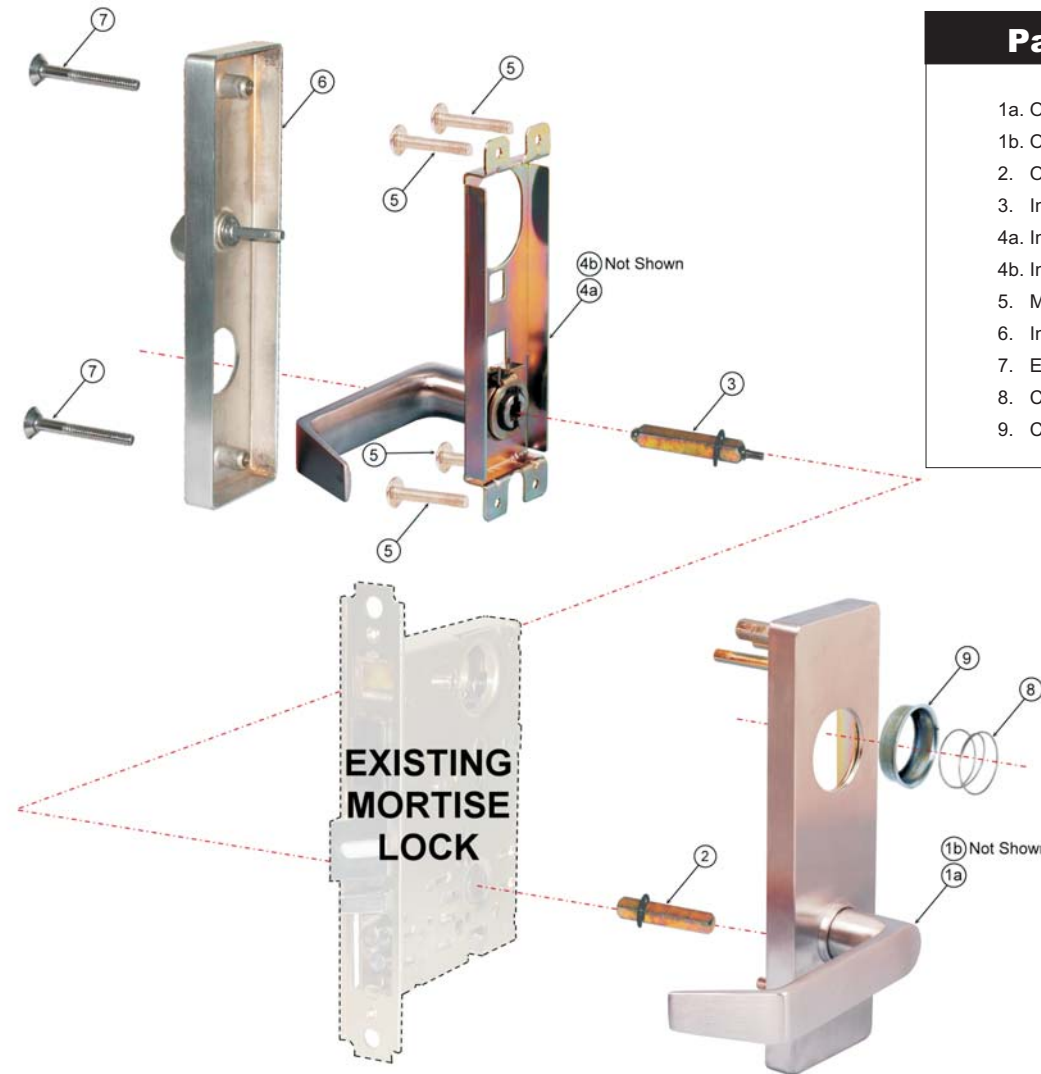

Parts List Description

- 1a. Outside Escutcheon Lever Assembly (1)
- 1b. Outside Escutcheon Knob Assembly (1)
- 2. Outside Spindle (1)
- 3. Inside Spindle (1)
- 4a. Inside Mounting Plate Lever Assembly (1)
- 4b. Inside Mounting Plate Knob Assembly (1)
- 5. Mounting Screws (4)
- 6. Inside Escutcheon (1)
- 7. Escutcheon Screws (2)
- 8. Compression Spring (1) *(Optional)*
- 9. Cylinder Collar (1) *(Optional)*

- Step 1: Prepare door per template (supplied).
- Step 2: Insert outside spindle (2) and inside spindle (3) to door lock, and tighten screw.
- Step 3: Install Outside Escutcheon Lever/Knob Assembly (1a) / (1b).
Optional: Install cylinder collar (9), compression spring (8) and mortise cylinder, then secure cylinder housing to mortise lock.
- Step 4: Install inside mounting plate lever/knob assembly (4a) / (4b) and secure with 4 mounting screws (5).
- Step 5: Slide inside escutcheon (6) onto inside lever/knob assembly (4a) / (4b) and secure with 2 escutcheon screws (7).